

COUNTY OF LOS ANGELES
ROAD DEPARTMENT

PRECISE
BENCH MARK LIST



ARCADIA QUAD

1975 ADJUSTMENT

P R E F A C E

The Road Department level net is composed of more than 2,000 miles of levels supporting in excess of 12,000 bench marks. In 1975, a major readjustment of the net was undertaken. To emphasize the complete break with previous elevations, the BY,BG & BL series bench marks have been relabeled CY,CG & CL, respectively.

To facilitate the adjustment, indexing, and distribution of adjusted values of the net, the County territory is divided into 34 quads or areas. For identification purposes each quad is given a name, viz., "Rosemead," "La Mirada," "Santa Fe," etc. When bench marks and elevations in the Road Department net are used, the name of the quad in which the bench mark is located and the date of the adjustment of the elevation must be included in the bench mark description, e.g.,

CG 6234 --L&BN IN CONC HDWL OF DRAIN PIPE UNDER DR 218 FT
NE&18 FT SE C/L INT GRAND AVE & CAMERON AVE MKD (BM)
(COVINA -1975) ELEV. 696.238

Experience indicates that this general adjustment will, for the most part, remain sound for the next 10 years. Updating constrained adjustments will be made in 5 years. It is expected that these updating adjustments will be in the nature of a few hundredths of a foot. When a quad is readjustment, new elevation lists will be published and the date of the readjustment will replace the "1975" at the end of the bench mark description. Two bench marks with different adjustment dates will not normally agree with each other.

The basic accuracy of the net is reflected by an indicated field probable error of plus or minus 0.012 foot per mile of leveling as determined from over 600 conditions of closure. However, many years experience in vertical control in the greater Los Angeles basin and Antelope Valley indicate that because of varying degrees of subsidence and heaving, the true datum is recovered only by obtaining substantial agreement of a number of bench marks.

The users of this net are invited to assist in its maintenance by notifying this Department of cases of obliteration, apparent mistakes in descriptions or elevations, and proven disturbance of bench marks.

DATUM: U. S. Coast and Geodetic Survey Sea Level Datum
of 1929, through the medium of the Los Angeles
County Engineer Precise Level Net.

ABBREVIATIONS USED IN BENCH MARK LISTINGS

| | | | |
|--------------------|--------------------------|-----------------|-------------------------|
| ABUT - - - - - | Abutment | EC - - - - - | End of Curve |
| ALG - - - - - | Along | ENT - - - - - | Entrance |
| ANG PT - - - - - | Angle Point | FL - - - - - | Floor |
| B/W - - - - - | Back of Walk | FTG - - - - - | Footing |
| BCR - - - - - | Beginning of Curb Return | FRWY - - - - - | Freeway |
| BC - - - - - | Beginning of Curve | F/W - - - - - | Front of Walk |
| BLDG - - - - - | Building | GAR - - - - - | Garage |
| EM - - - - - | Bench Mark | HDWL - - - - - | Headwall |
| BT SPK - - - - - | Boat or Bolt Spike | HSE - - - - - | House |
| BR CAP - - - - - | Brass or Bronze Cap | HWY - - - - - | Highway |
| C B - - - - - | Catch Basin | INT - - - - - | Intersection |
| CTR - - - - - | Center | IP - - - - - | Iron Pipe |
| C/L - - - - - | Center Line | LT - - - - - | Left |
| C/L INT - - - - - | Center Line Intersection | LACE - - - - - | L. A. City Engineer |
| C/L PROD - - - - - | Center Line Produced | LACS - - - - - | L. A. Co. Engineer |
| CONC - - - - - | Concrete | LAFC - - - - - | L. A. Co. Flood Control |
| COR - - - - - | Corner | L&BN - - - - - | Lead and Bench Nail |
| COE - - - - - | Corps of Engineers | L&BR - - - - - | Lead and Brad |
| CULV - - - - - | Culvert | L&N - - - - - | Lead and Nail |
| CYN - - - - - | Canyon | L&SPK - - - - - | Lead and Spike |
| CB - - - - - | Curb | L&T - - - - - | Lead and Tack |
| CS MON - - - - - | Co. Engineer Monument | MCR - - - - - | Middle of Curb Return |
| CT SPK - - - - - | Cut Spike | MKD - - - - - | Marked |
| DR - - - - - | Drive or Driveway | MC - - - - - | Middle of Curve |
| E/O - - - - - | East of | MON - - - - - | Monument |
| ECR - - - - - | End of Curb Return | N/O - - - - - | North of |

ABBREVIATIONS USED IN BENCH MARK LISTINGS . . . CONTINUED

NR - - - - - Near
OPP - - - - - Opposite
PI - - - - - Point of Intersection
PK&W - - - - - PK Nail and Washer
P/L - - - - - Property Line
POST - - - - - Point on Semi-Tangent
PP - - - - - Power Pole
PVMT - - - - - Pavement
PROD - - - - - Produced
RD - - - - - Road
RDEM - - - - - Road Dept. Bench Mark
RDEM TAG - - - - - Road Dept. Bench Mark Tag
RR - - - - - Railroad
RT - - - - - Right
R/W - - - - - Right of Way
SDMH - - - - - Storm Drain Manhole
SMH - - - - - Sewer Manhole
SPK - - - - - Spike
ST&W - - - - - Spike Tin and Washer
S/O - - - - - South of
TP - - - - - Telephone Pole
USC&GS - - - - - U. S. Coast and Geodetic Survey
USGS - - - - - U. S. Geological Survey
WK - - - - - Walk
W/O - - - - - West of

ARCADIA QUAD

2-10-78

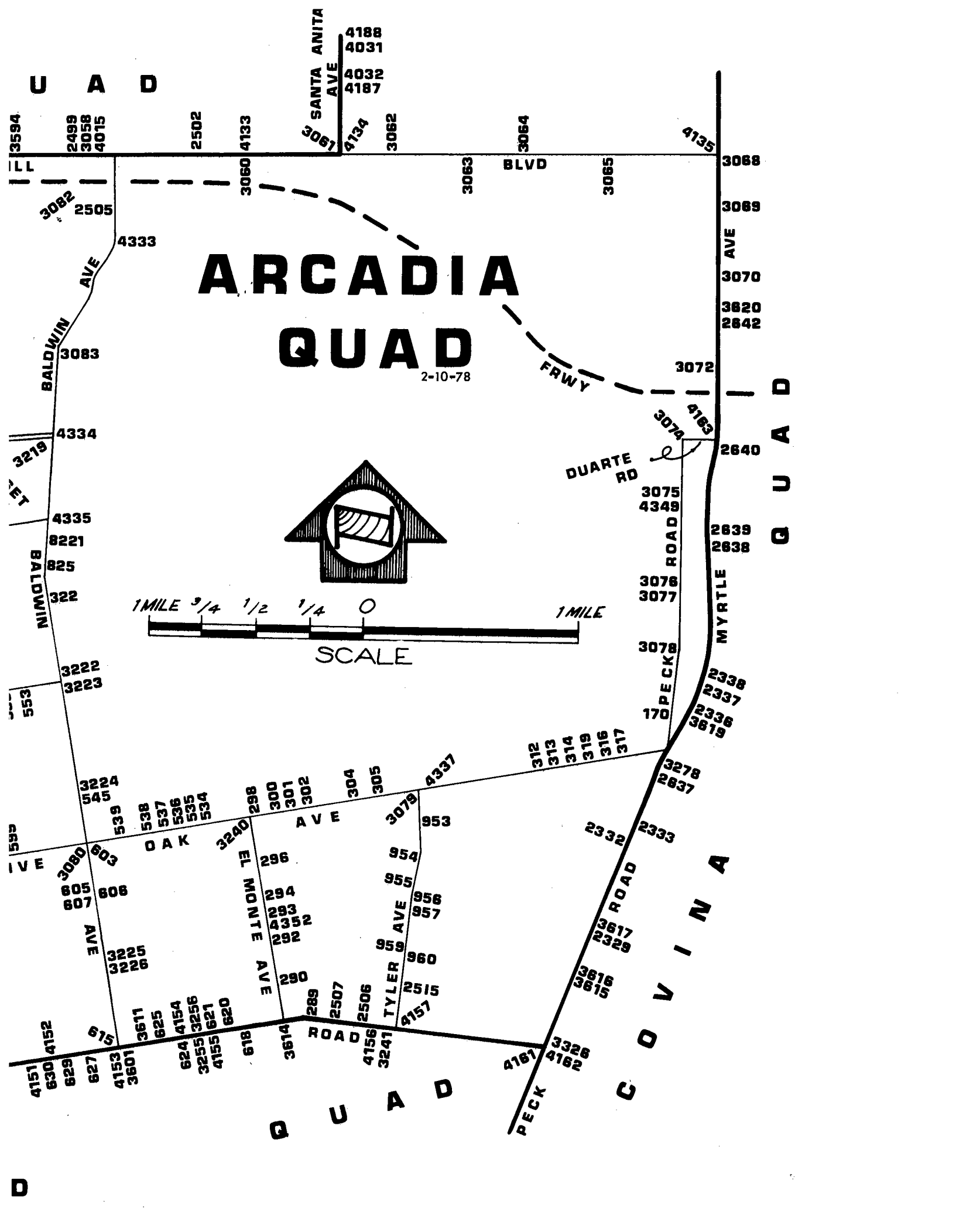
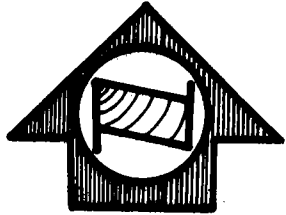

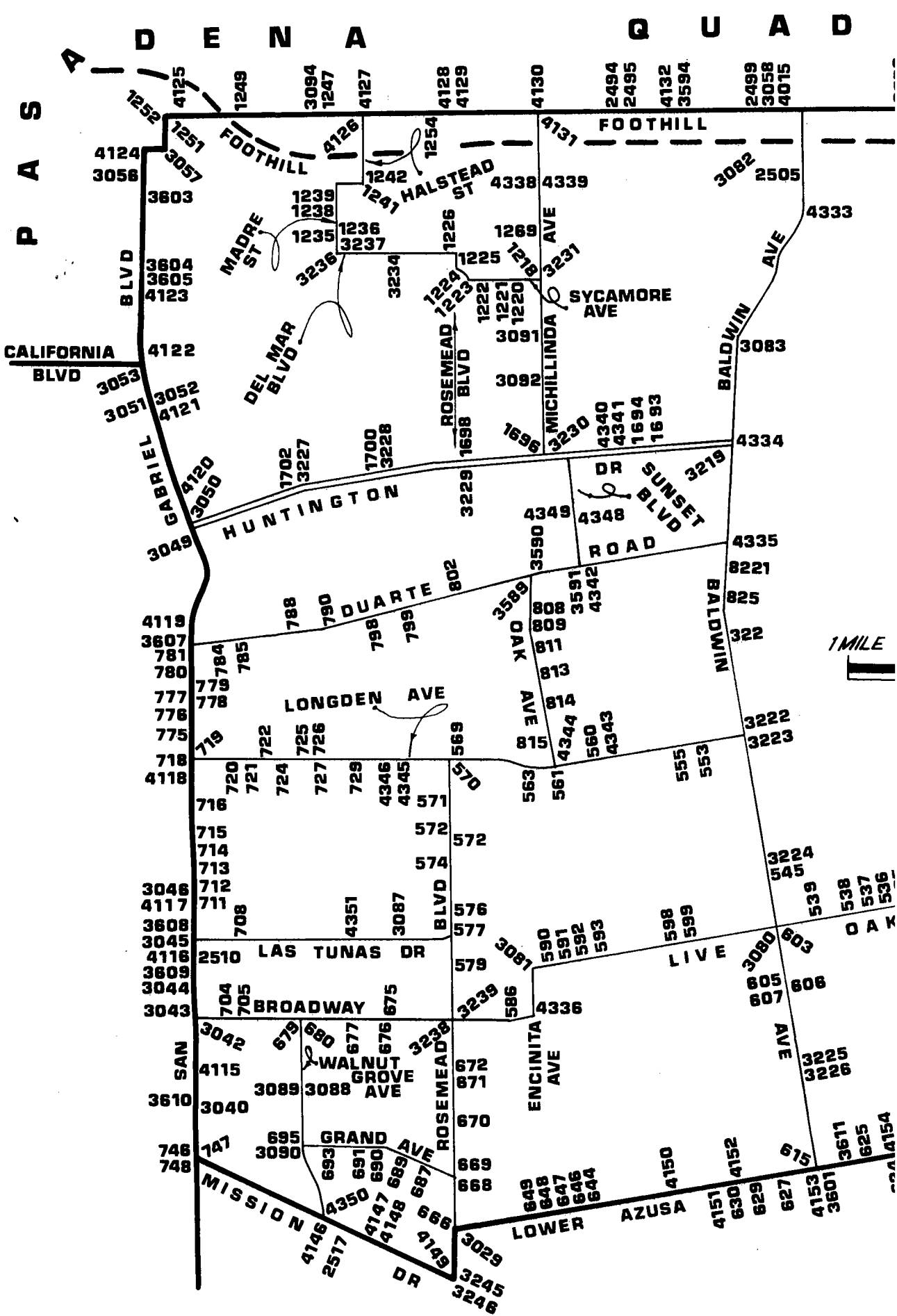

P A S A D E N A

Q U A D

CALIFORNIA BLVD

1252 4125 1249 3094 1247 4127 4128 4129 4130 2494 2495 4132 3594 2499 3058 4015

FOOTHILL

4124 3056 3603 1239 1238 1235 1236 3237 1242 1241 1226 1225 1219 4338 4339 3082 2505 4333

BLVD MADRE ST 1224 1223 1222 1221 1220 3091 3092 1698 1696 3230 3231 3234 3236 3237 3238 3239 3228 3229 1700 1702 3227 1698 1696 3230 3231 4340 4341 1694 1693

DEL MAR BLVD ROSEMEAD BLVD SYCAMORE AVE

3053 4122 3051 3052 4121 3049 3050 1700 1702 3227 1700 3228 3229 1698 1696 3230 3231 4340 4341 1694 1693

HUNTINGTON

3049 3050 1700 1702 3227 1700 3228 3229 1698 1696 3230 3231 4340 4341 1694 1693

DR SUNSET BLVD

3049 3050 1700 1702 3227 1700 3228 3229 1698 1696 3230 3231 4340 4341 1694 1693

DUARTE 802 801 800 799 798 797 796 795 794 793 792 791 790 789 788 787 786 785 784 783 782 781 780 779 778 777 776 775 774 773 772 771 770 769 768 767 766 765 764 763 762 761 760 759 758 757 756 755 754 753 752 751 750 749 748 747 746 745 744 743 742 741 740 739 738 737 736 735 734 733 732 731 730 729 728 727 726 725 724 723 722 721 720 719 718 717 716 715 714 713 712 711 710 709 708 707 706 705 704 703 702 701 700 699 698 697 696 695 694 693 692 691 690 689 688 687 686 685 684 683 682 681 680 679 678 677 676 675 674 673 672 671 670 669 668 667 666 665 664 663 662 661 660 659 658 657 656 655 654 653 652 651 650 649 648 647 646 645 644 643 642 641 640 639 638 637 636 635 634 633 632 631 630 629 628 627 626 625 624 623 622 621 620 619 618 617 616 615 614 613 612 611 610 609 608 607 606 605 604 603 602 601 600 599 598 597 596 595 594 593 592 591 590 589 588 587 586 585 584 583 582 581 580 579 578 577 576 575 574 573 572 571 570 569 568 567 566 565 564 563 562 561 560 559 558 557 556 555 554 553 552 551 550 549 548 547 546 545 544 543 542 541 540 539 538 537 536 535 534 533 532 531 530 529 528 527 526 525 524 523 522 521 520 519 518 517 516 515 514 513 512 511 510 509 508 507 506 505 504 503 502 501 500 499 498 497 496 495 494 493 492 491 490 489 488 487 486 485 484 483 482 481 480 479 478 477 476 475 474 473 472 471 470 469 468 467 466 465 464 463 462 461 460 459 458 457 456 455 454 453 452 451 450 449 448 447 446 445 444 443 442 441 440 439 438 437 436 435 434 433 432 431 430 429 428 427 426 425 424 423 422 421 420 419 418 417 416 415 414 413 412 411 410 409 408 407 406 405 404 403 402 401 400 399 398 397 396 395 394 393 392 391 390 389 388 387 386 385 384 383 382 381 380 379 378 377 376 375 374 373 372 371 370 369 368 367 366 365 364 363 362 361 360 359 358 357 356 355 354 353 352 351 350 349 348 347 346 345 344 343 342 341 340 339 338 337 336 335 334 333 332 331 330 329 328 327 326 325 324 323 322 321 320 319 318 317 316 315 314 313 312 311 310 309 308 307 306 305 304 303 302 301 300 299 298 297 296 295 294 293 292 291 290 289 288 287 286 285 284 283 282 281 280 279 278 277 276 275 274 273 272 271 270 269 268 267 266 265 264 263 262 261 260 259 258 257 256 255 254 253 252 251 250 249 248 247 246 245 244 243 242 241 240 239 238 237 236 235 234 233 232 231 230 229 228 227 226 225 224 223 222 221 220 219 218 217 216 215 214 213 212 211 210 209 208 207 206 205 204 203 202 201 200 199 198 197 196 195 194 193 192 191 190 189 188 187 186 185 184 183 182 181 180 179 178 177 176 175 174 173 172 171 170 169 168 167 166 165 164 163 162 161 160 159 158 157 156 155 154 153 152 151 150 149 148 147 146 145 144 143 142 141 140 139 138 137 136 135 134 133 132 131 130 129 128 127 126 125 124 123 122 121 120 119 118 117 116 115 114 113 112 111 110 109 108 107 106 105 104 103 102 101 100 99 98 97 96 95 94 93 92 91 90 89 88 87 86 85 84 83 82 81 80 79 78 77 76 75 74 73 72 71 70 69 68 67 66 65 64 63 62 61 60 59 58 57 56 55 54 53 52 51 50 49 48 47 46 45 44 43 42 41 40 39 38 37 36 35 34 33 32 31 30 29 28 27 26 25 24 23 22 21 20 19 18 17 16 15 14 13 12 11 10 9 8 7 6 5 4 3 2 1

1 MILE

R O S E M E A D

| QUAD-YEAR | ELEV | DESCRIPTION (INCLUDE QUAD AND YEAR IN DESCRIPTION) | BM NUMBER |
|-------------------|---------|---|-----------|
| ARCADIA (1975) | 358.930 | L&T 1FT E OF END OF CB @ SE COR PECK RD & LONGDEN AVE 90FT E & 38FT S C/L INT | CG 170 |
| ARCADIA (1975) | 309.703 | BT SPK E CB EL MONTE AVE 18FT N CONC DR TO HSE NO 4850 28FT E C/L 500FT N LOWER AZUSA RD MKD (TE 466) | CG 290 |
| ARCADIA (1975) | 323.167 | BT SPK E CB EL MONTE AVE 475FT S FREER ST MKD (TE 462) | CG 292 |
| ARCADIA (1975) | 326.813 | BT SPK W CB 10FT S BCR @ SW COR FREER ST & EL MONTE AVE MKD (TE 461) | CG 293 |
| ARCADIA (1975) | 332.599 | BT SPK E CB EL MONTE AVE 28FT E C/L & 28FT S C/L PROD OLIVE ST MKD (TE 459) | CG 294 |
| ARCADIA (1975) | 341.066 | BT SPK W CB EL MONTE AVE 7FT S C/L PROD DANBURY ST MKD (TE 553) | CG 296 |
| ARCADIA (1975) | 350.872 | BT SPK S CB 8FT E BCR @ SE COR LIVE OAK AVE & EL MONTE AVE MKD (TE 517) | CG 298 |
| ARCADIA (1975) | 351.197 | PK IN S CB 5FT E BCR @ SE COR PERSIMMON AVE & OAK AVE 58FT E & 38FT N/D C/L INT | CG 300 |
| ARCADIA (1975) | 351.927 | BT SPK 6FT W BCR @ SW COR MC CULLOCH AVE & LIVE OAK AVE MKD (TE 520) | CG 301 |
| ARCADIA (1975) | 352.295 | BT SPK 8FT W BCR @ SW COR WELLAND AVE & LIVE OAK AVE MKD (TE 522) | CG 302 |
| ARCADIA (1975) | 348.801 | BT SPK S CB LIVE OAK AVE 20FT W C/L PROD LOUISE AVE MKD (TE 526) | CG 304 |
| ARCADIA (1975) | 348.057 | BT SPK 4FT W BCR @ SW COR MYRTUS AVE & LIVE OAK AVE MKD (TE 527) | CG 305 |
| ARCADIA (1975) | 346.962 | L&T 4FT W BCR @ SW COR CENTER AVE & LIVE OAK AVE | CG 312 |
| ARCADIA (1975) | 347.404 | L&BN 5FT E BCR @ SW COR NINTH AVE & LIVE OAK AVE | CG 313 |
| ARCADIA (1975) | 347.880 | PK N CB SERVICE RD LIVE OAK AVE C/L PROD 10TH AVE & 105FT W C/L HODGES AVE | CG 314 |
| ARCADIA (1975) | 347.761 | L&T 1FT E BCR SERVICE RD @ SE COR EISENHOWER AVE & LIVE OAK AVE | CG 315 |
| ARCADIA (1975) | 349.568 | L&T S CB LIVE OAK AVE 1FT W ISLAND BCR @ SW COR MAYFLOWER AVE 38FT S & 35FT W C/L INT | CG 316 |

| QUAD-YEAR | ELEV | DESCRIPTION (INCLUDE QUAD AND YEAR IN DESCRIPTION) | BM NUMBER |
|-------------------|---------|--|-----------|
| ARCADIA (1975) | 352.019 | L&T 1FT W BCR @ SW COR LYND AVE & LIVE OAK AVE | CG 317 |
| ARCADIA (1975) | 356.212 | L&PK W CB 6FT N BCR @ NW COR LONGLEY WAY & LIVE OAK AVE MKD (TE 513) | CG 534 |
| ARCADIA (1975) | 359.960 | L&PK E CB 5FT N BCR @ NE COR WARREN WAY & LIVE OAK AVE MKD (TE 512) | CG 535 |
| ARCADIA (1975) | 362.408 | L&PK W CB 6FT N BCR @ NW COR CAROLINE WAY & LIVE OAK AVE MKD (TE 510) | CG 536 |
| ARCADIA (1975) | 363.689 | L&SPK E CB 9FT N BCR @ NE COR HOLLY AVE & LIVE OAK AVE MKD (TE 508) | CG 537 |
| ARCADIA (1975) | 366.579 | PK W CB 5FT N BCR @ NW COR WINTHROP AVE & LIVE OAK AVE MKD (TE 507) | CG 538 |
| ARCADIA (1975) | 369.752 | PK W CB 5FT N BCR @ NW COR BRADFORD AVE & LIVE OAK AVE MKD (TE 506) | CG 539 |
| ARCADIA (1975) | 387.981 | L&BN S CB LAS TUNAS DR 15FT E BCR @ SE COR BALDWIN AVE 84FT E & 57FT S/O C/L INT | CG 545 |
| ARCADIA (1975) | 430.606 | L&T CONC DR TO HSE NO 9846 1FT E OF W EDGE & 8FT S/O N EDGE 34FT S/O C/L LONGDEN AVE 18FT W/O C/L AGNES AVE PROD | CG 553 |
| ARCADIA (1975) | 433.463 | L&T CONC WALK TO HSE NO 6303 62FT W/O C/L GOLDEN WEST AVE 30FT N/O C/L LONGDEN AVE | CG 555 |
| ARCADIA (1975) | 442.791 | L&BN N CB OF LONGDEN AVE 18FT N C/L 15FT E OF DR TO GIRL SCOUTS BLDG NO 9509 & 300FT W PRIMROSE AVE | CG 560 |
| ARCADIA (1975) | 447.259 | L&SPK S CB 10FT E BCR @ SE COR OAK AVE & LONGDEN AVE MKD (TE 118) | CG 561 |
| ARCADIA (1975) | 449.180 | L & SPK W CB ENCINITA AVE 18FT W & 131FT S/O C/L INT LONGDEN AVE FRONT OF HSE NO 6261 MKD (TE119) | CG 563 |
| ARCADIA (1975) | 461.790 | L&BN E CB 1FT N BCR @ NE COR ROSEMEAD BLVD & LONGDEN AVE | CG 569 |
| ARCADIA (1975) | 460.001 | L&SPK E CB 5FT S BCR @ SE COR ROSEMEAD BLVD & LONGDEN AVE MKD (TE 142) | CG 570 |
| ARCADIA (1975) | 449.781 | L&BN W CB ROSEMEAD AVE 2FT N OF DR TO HSE NO 6165 800FT S LONGDEN AVE | CG 571 |
| ARCADIA (1975) | 438.392 | L&BN N CB 3FT W BCR @ NW COR ROSEMEAD BLVD & GARIBALDI AVE | CG 572 |

| QUAD-YEAR | ELEV | DESCRIPTION (INCLUDE QUAD AND YEAR IN DESCRIPTION) | BM NUMBER |
|--------------------|---------|---|-----------|
| ARCADIA (1975) | 436.931 | BT SPK IN E CB 6FT S BCR @ SE COR ROSEMEAD BLVD & GARIBALDI AVE MKD (TE 139) | CG 573 |
| ARCADIA (1975) | 427.738 | L&BN IN W CB ROSEMEAD BLVD 1FT N OF CONC DR TO HSE NO 5947 MIDWAY BET GARIBALDI AV & HERMOSA DR | CG 574 |
| ARCADIA (1975) | 412.629 | L&SPK E CB 6FT S BCR @ SE COR ROSEMEAD BLVD & ELM AVE MKD (TE 136) | CG 576 |
| ARCADIA (1975) | 408.875 | L&SPK E CB 29FT N BCR @ NE COR ROSEMEAD BLVD & LAS TUNAS DR MKD (TE 135) | CG 577 |
| ARCADIA (1975) | 405.338 | BT SPK E CB ROSEMEAD BLVD 22FT S/O C/L 1ST ALLEY S/O LAS TUNAS DR 122FT S/O BCR @ LAS TUNAS DR MKD (TE 785) | CG 579 |
| ARCADIA (1975) | 386.630 | L&SPK IN E CB RIO HONDO AVE 20FT N/O BCR 18FT E & 50FT N/O C/L INT LIVE OAK AVE | CG 590 |
| ARCADIA (1975) | 387.109 | L&SPK W CB 62FT N & 18FT W/O C/L INT ALESSANDRO AVE & LIVE OAK AVE MKD (TE 25) | CG 591 |
| ARCADIA (1975) | 386.123 | L&SPK W CB OAK AVE 15FT N/O BCR 18FT W & 43FT N/ C/L INT LIVE OAK AVE MKD (TE-26) | CG 592 |
| ARCADIA (1975) | 384.370 | L&SPK W CB CLOVERLY AVE 10FT N/O BCR 43FT N & 18 FT W/O C/L INT LIVE OAK AVE MKD (T27) | CG 593 |
| ARCADIA (1975) | 381.050 | L&BN E CB CAMELLIA AVE 38FT N/O BCR 18FT E & 80 FT N/O C/L INT LIVE OAK AVE | CG 598 |
| ARCADIA (1975) | 380.072 | L&SPK W CB KAUFFMAN AVE 22FT N/O BCR 18FT W & 64 FT N/O C/L INT LIVE OAK AVE MKD (TE 32) | CG 599 |
| ARCADIA (1975) | 369.279 | L&T W CB 1FT S BCR @ SW COR BALDWIN AVE & DUFFY ST 48FT S & 40FT W/O C/L INT | CG 603 |
| ARCADIA (1975) | 361.374 | L&T W CB 1FT S BCR @ SW COR BALDWIN AVE & BROADWAY 45FT S & 40FT W/O C/L INT | CG 605 |
| ARCADIA (1975) | 357.475 | CS BR CAP MON IN WELL C/L INT BALDWIN AVE & DAINES DR TO WEST | CG 606 |
| ARCADIA (1975) | 357.765 | L&T W CB 1FT S BCR @ SW COR BALDWIN AVE & DAINES DR TO WEST 40FT W & 40FT S/O C/L INT | CG 607 |
| BASELINE (1975) | 310.212 | L&SPK E CB 7FT N/O BCR @ NE COR LOWER AZUSA RD & BIRCHLAND PL 60FT N & 15FT E C/L INT MKD (TE 477) | CG 625 |

| QUAD-YEAR | ELEV | DESCRIPTION (INCLUDE QUAD AND YEAR IN DESCRIPTION) | BM NUMBER |
|--------------------|---------|---|-----------|
| BASELINE (1975) | 330.770 | USC & GS BR CAP MON IN W CONC CHANNEL WALL @ SW COR OF LOWER AZUSA RD BRIDGE NO B 1053 OVER EATON CYN WASH 34FT S C/L LOWER AZUSA RD & 200FT W C/L RIO HONDO AVE MKD (S 1142 1961) | CG 644 |
| BASELINE (1975) | 327.815 | L&BN (NO HEAD) S CB 38FT S C/L LOWER AZUSA RD & 37FT W INT SPRR & 437FT E INT ENCINITA AVE | CG 646 |
| BASELINE (1975) | 324.142 | L&SPK N CB 8FT E/O BCR @ NE COR LOWER AZUSA RD & ENCINITA AVE 50FT E & 28FT N C/L INT MKD (WM 254) | CG 647 |
| BASELINE (1975) | 323.771 | L&T N CB 1FT W BCR @ NW COR LOWER AZUSA RD & ENCINITA AVE 35FT W & 28FT N C/L INT | CG 648 |
| BASELINE (1975) | 322.167 | LACS BR CAP MON IN WELL @ C/L INT LOWER AZUSA RD & ENCINITA AVE MKD (RE 329) | CG 649 |
| BASELINE (1975) | 336.486 | L&T W CB 40FT W C/L ROSEMEAD BLVD & 50FT S C/L PROD LOWER AZUSA RD | CG 666 |
| ARCADIA (1975) | 348.250 | L&SPK W CB 6FT S BCR @ SW COR ROSEMEAD BLVD W SERVICE RD & GRAND AVE MKD (WM 3) | CG 668 |
| ARCADIA (1975) | 353.050 | L&BN 1FT UP IN S WALL @ W END SPRR BRIDGE OVER ROSEMEAD BLVD 70FT N C/L GRAND AVE | CG 669 |
| ARCADIA (1975) | 362.456 | L & T W CB OF W SERVICE RD 80FT W C/L ROSEMEAD BLVD ON C/L PENTLAND ST | CG 670 |
| ARCADIA (1975) | 373.664 | L&SPK E CB 10FT N BCR @ NE COR SERENO DR & ROSEMEAD BLVD (TE 776) | CG 671 |
| ARCADIA (1975) | 382.784 | FC DISC IN CONC WK NE COR BRIDGE NO 53- 329 OVER EATON WASH 4FT S BCR @ SE COR ROSEMEAD BLVD & OLIVE ST | CG 672 |
| ARCADIA (1975) | 395.183 | L&T W CB 5FT N/O END 40FT N & 20FT W/O C/L INT BROADWAY & MUSCATEL AVE TO THE N | CG 675 |
| ARCADIA (1975) | 395.447 | L&T W CB 18FT W & 77FT S/O C/L INT BROADWAY & MUSCATEL AVE TO THE S | CG 676 |
| ARCADIA (1975) | 399.538 | L&T S CB 1FT E BCR @ SE COR BROADWAY & N LA PRESA AVE 59FT E & 20FT S/O C/L INT | CG 677 |
| ARCADIA (1975) | 399.585 | L&T S EDGE CONC WK 5FT FROM END 30FT S C/L BROADWAY 35FT W C/L WALNUT GROVE AVE | CG 679 |
| ARCADIA (1975) | 398.509 | L&T N EDGE CONC DR @ SW COR BROADWAY & WALNUT GROVE AVE 133FT S & 33FT W/O C/L INT | CG 680 |

| QUAD-YEAR | ELEV | DESCRIPTION (INCLUDE QUAD AND YEAR IN DESCRIPTION) | BM NUMBER |
|-------------------|---------|--|-----------|
| ARCADIA (1975) | 351.384 | SPK NEAR S EDGE CONC WALK TO HSE NO 4756 38FT E C/L IVAR AVE & 100FT S C/L GRAND AVE (MKD WM 297) | CG 687 |
| ARCADIA (1975) | 361.395 | CS MON IN WELL @ P I OF GRAND AVE 6FT E/O CS MON @ C/L MUSCATEL AVE | CG 689 |
| ARCADIA (1975) | 361.530 | CS MON IN WELL @ C/L INT GRAND AVE & MUSCATEL AVE 6FT W/O CS MON @ P I GRAND AVE | CG 690 |
| ARCADIA (1975) | 367.598 | L&T S CB 1FT W BCR @ SW COR GRAND AVE & BARTLETT AVE | CG 691 |
| ARCADIA (1975) | 371.254 | L&T S CB 1FT E BCR @ SE COR GRAND AVE & HALKETT AVE | CG 693 |
| ARCADIA (1975) | 372.097 | SPK N CB GRAND AVE 4FT E C/L PROD WILLARD AVE 5FT W OF END OF CB 197FT W/O C/L WALNUT GROVE AVE MKD (W M 401) | CG 695 |
| ARCADIA (1975) | 398.400 | L&T W CB 3FT N BCR @ NW COR CHARLOTTE AVE & BROADWAY 33FT N & 20FT W/O C/L INT | CG 704 |
| ARCADIA (1975) | 398.350 | L&T E CB 3FT N/O BCR @ NE COR BROADWAY & CHARLOTTE AVE 33FT N & 20FT E/O C/L INT | CG 705 |
| ARCADIA (1975) | 416.787 | L&SPK N CB 22FT E BCR @ NE COR LAS TUNAS DR & CHARLOTTE AVE MKD (BM 216) | CG 708 |
| ARCADIA (1975) | 446.966 | SPK S CB 10FT E/O BCR @ SE COR SAN GABRIEL BLVD & HERMOSA DR 57FT E & 20FT S/O C/L INT | CG 711 |
| ARCADIA (1975) | 451.682 | SPK E CB 5FT S/O BCR @ SE COR LESLIE DR & SAN GABRIEL BLVD 61FT S & 36FT E/O C/L INT | CG 712 |
| ARCADIA (1975) | 456.855 | L&T S CB 2FT E BCR @ SE COR SAN GABRIEL BLVD & SANTA YNEZ ST 74FT E & 16FT S/O C/L INT | CG 713 |
| ARCADIA (1975) | 461.746 | L&T S CB 3FT E BCR @ SE COR BEVAN ST & SAN GABRIEL BLVD 16FT S & 75FT E/O C/L INT | CG 714 |
| ARCADIA (1975) | 466.545 | SPK E CB 6FT S BCR @ SE COR GARIBALDI AVE & SAN GABRIEL BLVD 51FT S & 38FT E/O C/L INT | CG 715 |
| ARCADIA (1975) | 472.881 | SPK E CB 9FT N/O BCR @ NE COR BEVERLY DR & SAN GABRIEL BLVD 37FT N & 38FT E/O C/L INT | CG 716 |
| ARCADIA (1975) | 483.220 | RD BR CAP MON IN WELL @ C/L INT SAN GABRIEL BLVD & LONGDEN AVE | CG 718 |
| ARCADIA (1975) | 483.154 | L&T S CB 19FT E CB RET @ SE COR LONGDEN AVE & SAN GABRIEL BLVD 20FT S & 72FT E/O C/L INT | CG 719 |

| QUAD-YEAR | ELEV | DESCRIPTION (INCLUDE QUAD AND YEAR IN DESCRIPTION) | BM NUMBER |
|--------------------|---------|--|-----------|
| ARCADIA (1975) | 475.884 | SPK S CB LONGDEN AVE 5FT E C/L PROD CHARLOTTE AVE MKD (TE 612) | CG 720 |
| ARCADIA (1975) | 474.423 | SPK S CB LONGDEN AVE 5FT W C/L PROD LONGMONT AVE MKD (TE 611) | CG 721 |
| ARCADIA (1975) | 469.328 | L&T N CB 1FT E BCR @ NE COR LONGDEN AVE & DEL LOMA AVE 25FT E & 18FT N/O C/L INT | CG 722 |
| ARCADIA (1975) | 467.800 | L&BN S CB 1FT E BCR @ SE COR LONGDEN AVE & WILLARD AVE 20FT S & 40FT E/O C/L INT | CG 724 |
| ARCADIA (1975) | 469.322 | L&BN N CB 1FT W BCR @ NW COR LONGDEN AVE & DEERFIELD AVE MKD (TE 608) | CG 725 |
| ARCADIA (1975) | 470.502 | L&BN N CB 5FT W BCR @ NW COR LONGDEN AVE & VISTA ST TO N 18FT N & 34FT W/O C/L INT | CG 726 |
| ARCADIA (1975) | 469.450 | L&BN E CB 1FT S BCR @ SE COR LONGDEN AVE & BION AVE MKD (TE 607) | CG 727 |
| ARCADIA (1975) | 469.391 | L&SPK E CB BURTON AVE 12FT S OF END OF CB 42FT S C/L LONGDEN AVE MKD (TE 606) | CG 729 |
| BASELINE (1975) | 366.248 | L&T CTR OF CB RET @ NW COR SAN GABRIEL BLVD & MISSION DR 43FT W & 53FT N C/L INT | CG 746 |
| BASELINE (1975) | 365.422 | LACS BR CAP MON IN WELL C/L INT SAN GABRIEL BLVD & MISSION DR MKD (EL MONTE B-2 1940 RE2177) | CG 747 |
| BASELINE (1975) | 365.641 | L&T W CB 7FT S BCR @ SW COR SAN GABRIEL BLVD & MISSION DR 30FT S & 38FT W C/L INT | CG 748 |
| ARCADIA (1975) | 490.171 | L&SPK W CB 6FT N BCR @ NW COR LOS OLIVOS DR TO W & SAN GABRIEL BLVD 39FT N & 38FT W/O C/L INT MKD (TE)615) | CG 775 |
| ARCADIA (1975) | 496.372 | SPK W CB 10FT N BCR @ NW COR SOMERSET PL & SAN GABRIEL BLVD 44FT N & 37FT W/O C/L INT MKD (616) | CG 776 |
| ARCADIA (1975) | 504.157 | L&SPK W CB 6FT S BCR @ SW COR SHEFFIELD RD & SAN GABRIEL BLVD 43FT S & 37FT W/O C/L INT MKD (TE 617) | CG 777 |
| ARCADIA (1975) | 504.570 | RD BR CAP MON IN WELL C/L INT SAN GABRIEL BLVD & SHEFFIELD RD | CG 778 |
| ARCADIA (1975) | 506.154 | L&SPK E CB 8FT N/O BCR @ NE COR SHEFFIELD RD & SAN GABRIEL BLVD 44FT N & 38FT E/O C/L INT MKD (TE)618) | CG 779 |

| QUAD-YEAR | ELEV | DESCRIPTION (INCLUDE QUAD AND YEAR IN DESCRIPTION) | BM NUMBER |
|-------------------|---------|--|-----------|
| ARCADIA (1975) | 513.634 | L&SPK W CB 10FT N/O BCR @ NW COR WOODLAWN AVE & SAN GABRIEL BLVD 59FT N & 37FT W/O C/L INT MKD (TE 619) | CG 780 |
| ARCADIA (1975) | 528.441 | RD BR CAP MON IN WELL C/L INT DUARTE RD & SAN GABRIEL BLVD | CG 781 |
| ARCADIA (1975) | 526.638 | L&SPK W CB 6FT S BCR @ SW COR DUARTE RD & PROVENCE RD MKD (TE 338) | CG 784 |
| ARCADIA (1975) | 523.487 | L&T S CB 1FT W BCR @ SE COR DUARTE RD & KIMDALE RD 40FT S & 32FT E/O C/L INT | CG 785 |
| ARCADIA (1975) | 515.746 | SPK W CB VISTA ST 10FT N END CB & 45FT N C/L DUARTE RD MKD (TE 335) | CG 788 |
| ARCADIA (1975) | 510.104 | CS MON IN 2IN I P IN WELL @ C/L INT LA PRESA DR & DUARTE RD 6FT W/O PI OF CURVE ON C/L DUARTE RD (USE S EDGE OF PIPE) | CG 790 |
| ARCADIA (1975) | 511.410 | L&SPK E CB DR TO HSE NO 8712 32FT S & 27FT E C/L INT MUSCATEL AVE TO THE N & DUARTE RD MKD (TE 329) | CG 798 |
| ARCADIA (1975) | 515.423 | L&T E CB OF DR TO HSE NO 8850 55FT S C/L DUARTE RD & 185FT E C/L MAYESDALE AVE | CG 799 |
| ARCADIA (1975) | 513.263 | RDBM TAG IN N CB DUARTE RD 2FT W CB RET @ NW COR OF ROSEMEAD BLVD 40FT N & 62FT W C/L INT | CG 802 |
| ARCADIA (1975) | 495.956 | L&SPK E CB 12FT S BCR @ SE COR OAK AVE & NAOMI AVE MKD (TE 352) | CG 808 |
| ARCADIA (1975) | 489.408 | L&SPK E CB OAK AVE 12FT N C/L ARDENDALE AVE FRONT OF HSE NO 6734 MKD (TE 353) | CG 809 |
| ARCADIA (1975) | 482.733 | L&SPK E CB OAK AVE 5FT S C/L PROD CAMINO REAL TO W MKD (TE 355) | CG 811 |
| ARCADIA (1975) | 471.712 | SPK E CB OAK AVE 3FT N C/L PROD EMPEROR AVE TO W MKD (TE 357) | CG 813 |
| ARCADIA (1975) | 466.359 | L&SPK E CB 2FT S BCR @ SE COR OAK AVE & LEMON AVE MKD (TE 199) | CG 814 |
| ARCADIA (1975) | 453.507 | L&SPK W CB OAK AVE 35FT S C/L PROD OLEMA ST FRONT OF HSE NO 6333 MKD (TE 204) | CG 815 |
| ARCADIA (1975) | 478.448 | L&BN E CB 10FT S BCR @ SE COR DUARTE RD & BALDWIN AVE 30FT E & 45FT S/O C/L INT | CG 822 |

| QUAD-YEAR | ELEV | DESCRIPTION (INCLUDE QUAD AND YEAR IN DESCRIPTION) | BM NUMBER |
|-------------------|---------|---|-----------|
| ARCADIA (1975) | 466.938 | RDBM TAG IN E CB BALDWIN AVE 50FT N CB RET @ NE COR CAMINO REAL AVE TO E 32FT E & 92FT N C/L INT | CG 825 |
| ARCADIA (1975) | 339.696 | L&T E CB TYLER AVE ON C/L PROD DANESWOOD AVE | CG 953 |
| ARCADIA (1975) | 332.080 | SPK W CB 5FT S BCR @ SW COR DAINES DR & TYLER AVE MKD (TE 534) | CG 954 |
| ARCADIA (1975) | 327.613 | L&SPK W CB 8FT S BCR @ SW COR WILDFLOWER RD & TYLER AVE MKD (TE 535) | CG 955 |
| ARCADIA (1975) | 324.977 | L&SPK E CB TYLER AVE 10FT S C/L PROD FREER ST MKD (TE 536) | CG 956 |
| ARCADIA (1975) | 324.211 | L&T E CB 1FT S BCR @ SE COR TYLER AVE & MILDOANN ST 59FT S & 20FT E/O C/L INT | CG 957 |
| ARCADIA (1975) | 308.802 | L & BN IN W WALL OF DRAINAGE CHANNEL 22FT W C/L TYLER AVE & 130FT S/O C/L ROCKFIELD DR MKD (S D 605) | CG 959 |
| ARCADIA (1975) | 308.174 | L&N IN E WALL DRAINAGE CHANNEL 30FT W C/L TYLER AVE & 275FT S/O C/L ROCKFIELD DR MKD (S D 601) | CG 960 |
| ARCADIA (1975) | 601.590 | CS MON IN WELL 1FT W & 1FT N/O BCR @ NW COR MICHILLINDA AVE & SCYAMORE AVE | CG 1218 |
| ARCADIA (1975) | 615.127 | L&T W EDGE CONC DR TO HSE NO 3834 SYCAMORE AVE 35FT S C/L & 0.1 MI W/O C/L MICHILLINDA AVE | CG 1220 |
| ARCADIA (1975) | 617.986 | L&T W EDGE CONC DR TO HSE NO 3798 SYCAMORE AVE 35FT S C/L 0.1 MI E/O WALNUT DR | CG 1221 |
| ARCADIA (1975) | 623.652 | L&SPK 2FT E BCR @ SE COR WALNUT DR & SYCAMORE AVE 15FT S & 50FT E/O C/L INT | CG 1222 |
| ARCADIA (1975) | 623.932 | L&T IN CONC APRON OF DR TO HSE NO 325 WALNUT DR ON C/L PROD SYCAMORE AVE | CG 1223 |
| ARCADIA (1975) | 629.587 | L&T 1FT S BCR @ SE COR MOUNTAIN VIEW AVE & ROSEMEAD BLVD 38FT S & 42FT E/O C/L INT | CG 1224 |
| ARCADIA (1975) | 630.887 | L&T 1FT N BCR @ NE COR MOUNTAIN VIEW AVE & ROSEMEAD BLVD 36FT N & 42FT E/O C/L INT | CG 1225 |
| ARCADIA (1975) | 635.521 | L&T E CB ROSEMEAD BLVD ON C/L PROD DEL MAR BLVD | CG 1226 |
| ARCADIA (1975) | 666.439 | L&T 3FT S BCR @ SE COR MILTON ST & MADRE ST 20FT E & 31FT S/O C/L INT | CG 1235 |

| QUAD-YEAR | ELEV | DESCRIPTION (INCLUDE QUAD AND YEAR IN DESCRIPTION) | BM NUMBER |
|--------------------|---------|--|-----------|
| ARCADIA (1975) | 672.392 | L&T 2FT S BCR @ SE COR BRANDON ST & MADRE ST 20FT E & 37FT S/O C/L INT | CG 1236 |
| ARCADIA (1975) | 678.832 | L&T 6FT S BCR @ SE COR GREEN ST & MADRE ST 20FT E & 35FT S/O C/L INT | CG 1238 |
| ARCADIA (1975) | 684.948 | BT SPK 6FT E/O BCR @ SE COR MADRE ST & COLORADO BLVD MKD (TE 683) | CG 1239 |
| ARCADIA (1975) | 680.413 | L&T 1FT W/O BCR @ NW COR HALSTEAD ST & COLORADO BLVD 38FT N & 44FT W/O C/L INT | CG 1241 |
| ARCADIA (1975) | 680.065 | L&T 1FT N/O BCR @ NE COR HALSTEAD ST & COLORADO BLVD 63FT N & 18FT E/O C/L INT | CG 1242 |
| BASELINE (1975) | 714.305 | L&BN 29FT N/O BCR @ NE COR SIERRA MADRE VILLA AVE & FOOTHILL BLVD 98FT N & 28FT E C/L INT | CG 1247 |
| BASELINE (1975) | 720.743 | RAMSET 1FT W BCR @ NW COR SANTA PAULA AVE & FOOTHILL BLVD 51FT W & 30FT N C/L INT | CG 1249 |
| BASELINE (1975) | 739.232 | L&BT SPK 2FT E BCR @ SE COR DAISY AVE & FOOTHILL BLVD 42FT E & 32FT S C/L INT | CG 1251 |
| BASELINE (1975) | 738.135 | LACS BM MON IN WELL 51FT S & 15FT E OF C/L INT FOOTHILL BLVD & DAISY AVE MKD (BM 10-8 1952 RE 63) | CG 1252 |
| BASELINE (1975) | 687.629 | L&BN S CB FOOTHILL BLVD 0.1MI W INT ROSEMEAD BLVD 34FT S C/L IN CTR C B FRONT OF BLDG NO 3600 | CG 1254 |
| ARCADIA (1975) | 613.523 | L&BN IN W CB MICHILLINDA AVE 1FT N CB RET @ NW COR BLANCHE AVE 20FT W & 34FT N C/L INT | CG 1269 |
| ARCADIA (1975) | 523.116 | RDBM TAG N CB OF ISI 1FT W ANG PT 30FT S C/L HUNTINGTON DR N BARREL 50FT W/O C/L GOLDEN WEST AVE | CG 1693 |
| ARCADIA (1975) | 523.501 | L&T N CB 3FT W BCR 30FT N/O C/L HUNTINGTON DR N BARREL & 54FT W/O C/L GOLDEN WEST AVE | CG 1694 |
| ARCADIA (1975) | 550.332 | CS MON IN WELL 11IN DN 1FT BACK OF CB @ BCR @ NW COR HUNTINGTON DR & MICHILLINDA AVE MKD (BM 20-7) | CG 1696 |
| ARCADIA (1975) | 563.436 | SQ HD SPK W CB 45FT N BCR 85FT N C/L HUNTINGTON DR N & 45FT W C/L ROSEMEAD BLVD MKD (SD 809) | CG 1698 |
| ARCADIA (1975) | 568.959 | L&SPK W CB 4FT N BCR 64FT N/O C/L HUNTINGTON DR N BARREL 20FT W/O C/L MADRE ST | CG 1700 |

| QUAD-YEAR | ELEV | DESCRIPTION (INCLUDE QUAD AND YEAR IN DESCRIPTION) | BM NUMBER |
|--------------------|---------|--|-----------|
| ARCADIA (1975) | 587.530 | BT SPK W CB 1FT S CATCH BASIN 20FT W C/L LA PRESA DR 80FT N/O C/L HUNTINGTON DR N BARREL MKD (TE 637) | CG 1702 |
| BASELINE (1975) | 336.941 | L&T @ NE COR CONC WK OF BLDG NO 5343 @ SW COR PECK RD & RIO HONDO PKWY 147FT S & 78FT W/O C/L INT MKD (BM) | CG 2329 |
| BASELINE (1975) | 338.560 | FC MON IN N END OF CB ON BRIDGE NO B 1270 40FT W C/L PECK RD & 1000FT N CLARK ST MKD (BM 67-75) | CG 2332 |
| BASELINE (1975) | 339.265 | RDBM TAG CONC WALL OF WASH @ NE COR BRIDGE NO B1270 5FT E CB & 45FT E C/L PECK RD & 1000FT N CLARK ST | CG 2333 |
| BASELINE (1975) | 357.452 | RD MON IN WELL 6IN DN @ INT MYRTLE AVE & LONGDEN AVE | CG 2336 |
| BASELINE (1975) | 364.237 | L&T E CB MYRTLE AVE 40FT E C/L & 37FT S BCR OF ISL & 66FT S C/L CALIFORNIA AVE EXIT | CG 2337 |
| BASELINE (1975) | 365.158 | LAFC TAG W CB MYRTLE AVE 40FT W C/L & 5FT S/O C B & 46FT N CALIFORNIA AVE EXIT S TAG OF 2 TAGS | CG 2338 |
| BASELINE (1975) | 666.808 | SMALL SPK & W N CB 1FT E/O BCR @ NE COR DEXTER AVE & FOOTHILL BLVD 49FT E & 27FT N C/L INT | CG 2494 |
| BASELINE (1975) | 670.152 | L&BN E CB 1FT S/O BCR @ NE COR FOOTHILL BLVD N SERV RD & DEXTER AVE 25FT N & 21FT E C/L INT | CG 2495 |
| BASELINE (1975) | 635.601 | LAFC MON FL 1FT N/O N CB NW COR DRWY @ NW COR BALDWIN AVE & FOOTHILL BLVD 91FT W & 28FT N C/L INT MKD (BM 62-76 1937) | CG 2499 |
| BASELINE (1975) | 591.350 | LACS BR CAP MON IN WELL 1FT N C/L FOOTHILL BLVD & 70FT E C/L BURNELL OAKS LN MKD (SIERRA MADRE G 6 1940 RE2177) | CG 2502 |
| ARCADIA (1975) | 566.448 | L&SML BT SPK CONC CB CAMBRIDGE DR 36FT E BCR @ NE COR BALDWIN AVE 100FT E & 18FT N C/L INT | CG 2505 |
| BASELINE (1975) | 308.548 | LAFC MON IN E ABUT @ NE COR BRIDGE NO B1256 32FT RD BRIDGE NO B1256 OVER RIO HONDO RIVER 32FT N C/L LOWER AZUSA RD & 462FT E INT DALEVIEW AVE MKD (BM 62-128 1959) | CG 2506 |
| BASELINE (1975) | 306.908 | RDBM TAG IN N CB 3FT W NW COR BRIDGE NO B1256 (OVER RIO HONDO RIVER) 26FT N/O C/L LOWER AZUSA RD & 233FT E/O INT DALEVIEW AVE | CG 2507 |
| ARCADIA (1975) | 431.817 | LACS BR CAP MON IN WELL C/L INT LAS TUNAS DR & SAN GABRIEL BLVD MKD (RE 63) | CG 2510 |

| QUAD-YEAR | ELEV | DESCRIPTION (INCLUDE QUAD AND YEAR IN DESCRIPTION) | BM NUMBER |
|--------------------|---------|---|-----------|
| ARCADIA (1975) | 310.382 | L&BN IN W CB OF ARROYO HIGH SCHOOL FOOTBALL FIELD PKNG LOT @ MOST NLY ENT 45FT E C/L TYLER AVE & 800FT N LOWER AZUSA RD | CG 2515 |
| BASELINE (1975) | 353.258 | L&BN NR N EDGE OF CONC DRWY TO HSE NO 4471 BARTLETT AVE TO S @ SW COR OF MISSION DR 25FT W & 50FT S C/L INT | CG 2517 |
| BASELINE (1975) | 353.870 | FC BR CAP IN S END W WINGWALL OF BRIDGE NO 964 @ SE COR PECK RD & LIVE OAK ST 48FT S & 82FT E APPROX C/L INT MKD (67-76 1959) | CG 2637 |
| BASELINE (1975) | 386.872 | L&SPK IN W CB 6FT S BCR 55FT S & 45FT W C/L INT E ALTERN ST & S MYRTLE AVE MKD (LE 85) | CG 2638 |
| BASELINE (1975) | 387.470 | L&SPK S CB E ALTERN ST 10FT E BCR 20FT S & 79FT E C/L INT S MYRTLE AVE & E ALTERN ST MKD (LE 20) | CG 2639 |
| BASELINE (1975) | 432.120 | L&T E CB 15FT N BCR 75FT S & 43FT E C/L INT DUARTE RD & S MYRTLE AVE | CG 2640 |
| BASELINE (1975) | 499.580 | CE MON FLUSH IN W/LK BACK OF CB 30FT E BCR @ SE COR HUNTINGTON DR & MYRTLE AVE 126FT E & 36FT S C/L INT MKD (11-10A RE 5869 CE) | CG 2642 |
| BASELINE (1975) | 336.193 | L&T E CB 10FT S/O BCR @ SE COR ROSEMEAD BLVD & LOWER AZUSA RD 50FT S & 40FT E C/L INT | CG 3029 |
| ARCADIA (1975) | 384.008 | L&T IN E CB 10FT S/O BCR @ SE COR EL MONTE ST TO THE E & SAN GABRIEL BLVD 45FT S & 38FT E/O C/L INT | CG 3040 |
| ARCADIA (1975) | 405.574 | L&BN E CB 11FT S BCR @ SE COR SAN GABRIEL BLVD & BROADWAY 41FT S & 35FT E C/L INT | CG 3042 |
| ARCADIA (1975) | 406.398 | L&BR W CB 12FT N/O BCR CTR CB @ NW COR BROADWAY & SAN GABRIEL BLVD 42FT N & 35FT W/O C/L INT | CG 3043 |
| ARCADIA (1975) | 412.549 | LAFC BR DISC @ NW BRIDGE ABUT OVER RUBIO WASH 50FT W & 61FT S/O C/L INT SAN GABRIEL BLVD & WEDGEWOOD PL MKD (BM 58-523) | CG 3044 |
| ARCADIA (1975) | 431.757 | LACS BR CAP MON IN WELL 8FT S & 1FT E C/L INT SAN GABRIEL BLVD & LAS TUNAS DR MKD (SIERRA MADRE B-12 1940 RE2177) | CG 3045 |
| ARCADIA (1975) | 447.546 | RD BR CAP MON IN WELL C/L INT SAN GABRIEL BLVD & HERMOSA DR | CG 3046 |
| ARCADIA (1975) | 597.972 | L&BN S CB 60FT W BCR @ SW COR SAN GABRIEL BLVD & HUNTINGTON DR 139FT W & 88FT S/O C/L INT | CG 3049 |

| QUAD-YEAR | ELEV | DESCRIPTION (INCLUDE QUAD AND YEAR IN DESCRIPTION) | BM NUMBER |
|--------------------|---------|--|-----------|
| ARCADIA (1975) | 597.591 | L&BN N CB 25FT E BCR @ NE COR SAN GABRIEL BLVD & HUNTINGTON DR 110FT E & 75FT N/O C/L INT | CG 3050 |
| ARCADIA (1975) | 651.067 | LACS BM MON IN WELL @ SW COR LOMBARDY RD & SAN GABRIEL BLVD 45FT S & 25FT W/O C/L INT MKD (BM 10-6 1952 RE 63) | CG 3051 |
| ARCADIA (1975) | 653.233 | BT SPK E CB 5FT N/O BCR @ NE COR LOMBARDY RD & SAN GABRIEL BLVD 35FT N & 30FT E C/L INT | CG 3052 |
| BASELINE (1975) | 661.239 | SPK E CB 6FT S/O BCR @ SE COR CALIFORNIA BLVD & SAN GABRIEL BLVD 58FT S & 27FT E C/L INT | CG 3053 |
| BASELINE (1975) | 721.306 | SPK CTR CB RET @ NW COR COLORADO BLVD & SAN GABRIEL BLVD 41FT N & 34FT W C/L INT | CG 3056 |
| BASELINE (1975) | 727.818 | L&BN 5FT E/O BCR @ SE COR DAISY AVE & WALNUT AVE 35FT E & 30FT S C/L INT | CG 3057 |
| BASELINE (1975) | 635.348 | LACS BM MON DN 4IN 1FT S/O S CB N SERV RD 2FT W/O BCR @ NE COR BALDWIN AVE & FOOTHILL BLVD 43FT E & 47FT N C/L INT MKD (BM 10-12A 1962 RE5869) | CG 3058 |
| BASELINE (1975) | 556.954 | RAMSET 1FT S BCR @ SW COR FOOTHILL BLVD & RANCHO RD 61FT S & 18FT W C/L INT | CG 3060 |
| BASELINE (1975) | 543.075 | LACS BR CAP MON IN WELL C/L FOOTHILL BLVD 26FT E C/L SANTA ANITA AVE MKD (SIERRA MADRE I-6 1940 RE2177) | CG 3061 |
| ARCADIA (1975) | 539.321 | MWD BR DISC NE ABUT OF BRIDGE OVER SANTA ANITA WASH 50FT N C/L FOOTHILL BLVD & 277FT E/O INT HIGHLAND OAKS MKD (53 K 1933) | CG 3062 |
| ARCADIA (1975) | 510.193 | L&BR CTR CB RET @ SE COR FOOTHILL BLVD & FIFTH ST 34FT S & 26FT E/O C/L INT | CG 3063 |
| ARCADIA (1975) | 507.340 | LACS BR CAP MON IN WELL C/L FOOTHILL BLVD 43FT E/O C/L MC KINLEY PL MKD (SIERRA MADRE K6A 1940 RE 2177) | CG 3064 |
| ARCADIA (1975) | 548.231 | LACS BR CAP MON IN WELL 37FT E & 8FT N C/L INT MAYFLOWER AVE & FOOTHILL BLVD MKD (SIERRA MADRE K-6 1940 RE2177) | CG 3065 |
| BASELINE (1975) | 576.442 | L&BR CTR CB RET @ SE COR FOOTHILL BLVD & MYRTLE AVE 41FT S & 33FT E/O C/L INT | CG 3068 |
| BASELINE (1975) | 554.843 | L&BR CTR CB RET @ SE COR MYRTLE AVE & LIME AVE 32FT E & 24FT S C/L INT | CG 3069 |

| QUAD-YEAR | ELEV | DESCRIPTION (INCLUDE QUAD AND YEAR IN DESCRIPTION) | BM NUMBER |
|--------------------|---------|---|-----------|
| BASELINE (1975) | 517.927 | L&T CTR CB RET @ NE COR MYRTLE AVE & CHESTNUT AVE 25FT N & 35FT E/O C/L INT | CG 3070 |
| BASELINE (1975) | 470.510 | L&N 5FT N BCR @ NW COR MYRTLE AVE & MONTANA AVE 35FT N & 30FT W C/L INT | CG 3072 |
| ARCADIA (1975) | 425.730 | L&T CTR CB RET @ SE COR PECK RD & DUARTE RD 49FT S & 25FT E/O C/L INT | CG 3074 |
| ARCADIA (1975) | 403.038 | L&T 1FT S BCR @ NW COR PECK RD & CHULA ST 40FT N & 20FT W C/L INT | CG 3075 |
| ARCADIA (1975) | 380.169 | CS MON IN WELL 51FT E & 23FT S/O C/L INT PECK RD & CAMINO REAL | CG 3076 |
| ARCADIA (1975) | 381.292 | L&T 3FT E BCR @ SE COR PECK RD & CAMINO REAL 54FT E & 25FT S C/L INT | CG 3077 |
| ARCADIA (1975) | 368.266 | L&T E CB PECK RD 10FT N/O C/L PROD JEFFRIES AVE | CG 3078 |
| ARCADIA (1975) | 342.858 | L&T 5FT W BCR @ SW COR LIVE OAK AVE & TYLER AVE 57FT W & 38FT S C/L INT | CG 3079 |
| ARCADIA (1975) | 373.786 | L&BN 11FT S/O BCR @ SW COR LIVE OAK AVE & BALDWIN AVE 56FT S & 40FT W/O C/L INT | CG 3080 |
| ARCADIA (1975) | 385.493 | L&T CTR C B @ NE COR LIVE OAK AVE & ENCINITA AVE 43FT E & 20FT N/O C/L INT | CG 3081 |
| ARCADIA (1975) | 594.832 | L&T N CB COLORADO ST ON C/L PROD BALDWIN AVE TO NO 9FT E/O L&BR APPROX 552FT E/O INT OLD RANCH RD | CG 3082 |
| ARCADIA (1975) | 502.430 | L&T 2FT S BCR @ SW COR BALDWIN AVE & HUGO RIED DR 50FT S & 40FT W/O C/L INT | CG 3083 |
| ARCADIA (1975) | 417.913 | SPK 15FT E BCR @ NE COR LAS TUNAS DR & MUSCATEL AVE 55FT N & 53FT E/O C/L INT | CG 3087 |
| ARCADIA (1975) | 386.016 | L&BRAD 1FT N BCR @ NW COR E CLANTON ST & WALNUT-GROVE AVE 50FT N & 20FT W C/L INT | CG 3088 |
| ARCADIA (1975) | 385.292 | L&T 1FT S BCR @ SW COR E CLANTON ST & WALNUT GROVE AVE 50FT S & 20FT W C/L INT | CG 3089 |
| ARCADIA (1975) | 371.496 | L&T 5FT E BCR @ SE COR GRAND AVE & WALNUT GROVE 65FT E & 20FT S C/L INT | CG 3090 |
| ARCADIA (1975) | 583.033 | SPK W CB MICHILLINDA AVE 5FT N C/L PROD HUGO RIED DR MKD (TE 431) | CG 3091 |

| QUAD-YEAR | ELEV | DESCRIPTION (INCLUDE QUAD AND YEAR IN DESCRIPTION) | BM NUMBER |
|--------------------|---------|--|-----------|
| ARCADIA (1975) | 560.519 | SPK 9FT N BCR @ NW COR MICHILLINDA AVE & CALIFORNIA BLVD MKD (TE 432) | CG 3092 |
| BASELINE (1975) | 714.005 | LACS BM MON IN WELL 1FT E/O E CB @ NE COR 117FT N & 29FT E C/L INT FOOTHILL BLVD & SIERRA MADRE VILLA AVE MKD (BM 10-9A RE5869 1962) | CG 3094 |
| ARCADIA (1975) | 493.767 | L & BR @ NW BCR OF ISLAND ON HUNTINGTON DRIVE & BALDWIN AVE 31FT S & 49FT W/O C/L INT N BARREL | CG 3219 |
| ARCADIA (1975) | 456.042 | L&PK 6FT S/O BCR 45FT S & 40FT W/O C/L INT BALDWIN AVE & CALLITA AVE | CG 3221 |
| ARCADIA (1975) | 428.974 | RD HD SPK 5FT N/O BCR 53FT N & 40FT W/O C/L INT BALDWIN AVE & LONGDEN AVE | CG 3222 |
| ARCADIA (1975) | 427.460 | L&BN 1FT S/O BCR 51FT S & 40FT W/O C/L INT BALDWIN AVE & LONGDEN AVE MKD (BM) | CG 3223 |
| ARCADIA (1975) | 390.516 | L&PK 5FT N/O BCR 44FT N & 39FT E/O C/L INT BALDWIN AVE & LAS TUNAS DR | CG 3224 |
| ARCADIA (1975) | 339.914 | L&BN E CB @ C B 65FT N & 40FT E/O C/L INT BALDWIN AVE & GREEN ST MKD (BM) | CG 3225 |
| ARCADIA (1975) | 338.933 | L & BN E CB @ C B 63FT S & 40FT E C/L INT BALDWIN AVE & GREEN ST MKD (BM) | CG 3226 |
| ARCADIA (1975) | 584.377 | L & T N CB OF ISLAND NR C/L HUNTINGTON DRIVE 115FT E/O C/L LA PRESA DR | CG 3227 |
| ARCADIA (1975) | 567.288 | L & BN 21FT E BCR 70FT N & 89FT E C/L INT HUNTINGTON DR & MADRE ST | CG 3228 |
| ARCADIA (1975) | 560.534 | L & T 6FT N BCR 40FT E & 75FT S C/L INT HUNTINGTON DR & ROSEMEAD BLVD MKD (BM) | CG 3229 |
| ARCADIA (1975) | 552.382 | L & T 35FT N BCR 200FT N & 25FT E C/L INT HUNTINGTON DR & MICHILLINDA AVE | CG 3230 |
| ARCADIA (1975) | 601.231 | RD HD SPK 8FT S BCR 50FT S & 20FT W C/L INT SYCAMORE AVE & MICHILLINDA AVE MKD (TE 428) | CG 3231 |
| ARCADIA (1975) | 643.227 | SPK 30FT S BCR 85FT S & 18FT E C/L INT DEL MAR BLVD & LOTUS AVE MKD (S D 819) | CG 3234 |
| ARCADIA (1975) | 660.180 | L&T 3FT W/O BCR INTO RET 30FT N & 45FT E/O C/L INT DEL MAR BLVD & MADRE ST | CG 3236 |
| ARCADIA (1975) | 660.372 | L&T 3FT E/O BCR INTO RET 30FT S & 40FT W/O C/L INT DEL MAR BLVD & MADRE ST | CG 3237 |

| QUAD-YEAR | ELEV | DESCRIPTION (INCLUDE QUAD AND YEAR IN DESCRIPTION) | BM NUMBER |
|--------------------|---------|---|-----------|
| ARCADIA (1975) | 386.682 | L&T 2FT W/O BCR 30FT S & 67FT W/O C/L INT ROSEMEAD BLVD & BROADWAY | CG 3238 |
| ARCADIA (1975) | 386.071 | STATE HWY BR CAP MON IN WELL 12IN DN @ C/L INT ROSEMEAD BLVD & BROADWAY | CG 3239 |
| ARCADIA (1975) | 350.758 | L & BN NR BCR 38FT N & 50FT E C/L INT LIVE OAK AVE & EL MONTE AVE (MKD BM) | CG 3240 |
| BASELINE (1975) | 316.609 | L&BN 45FT E/O BCR 32FT N & 107FT E C/L INT LOWER AZUSA RD & SANTA ANITA AVE MKD (BM) | CG 3241 |
| BASELINE (1975) | 333.088 | RDBM TAG 5FT W BCR 32FT N & 85FT W C/L INT ROSEMEAD BLVD & MISSION DR | CG 3245 |
| BASELINE (1975) | 332.417 | L & T 3FT N/O BCR 47FT N & 40FT E C/L INT ROSEMEAD BLVD & MISSION DR | CG 3246 |
| BASELINE (1975) | 306.375 | RDBM TAG 6FT E/O BCR 32FT S & 66FT E C/L INT LOWER AZUSA RD & ARDEN DR | CG 3255 |
| BASELINE (1975) | 353.750 | L&BN 2FT E/O BCR 40FT N & 122FT E/O C/L INT LIVE OAK AVE & PECK RD 2FT E/O W END BRIDGE NO 964 | CG 3278 |
| BASELINE (1975) | 323.433 | RDBM TAG 36FT N/O BCR 100FT N & 38FT E/O C/L INT LOWER AZUSA RD & PECK RD | CG 3326 |
| ARCADIA (1975) | 507.814 | RDBM TAG 2FT W BCR 32FT S & 60FT W C/L INT DUARTE RD & OAK AVE | CG 3589 |
| ARCADIA (1975) | 509.166 | L&T N CB DUARTE RD 32FT N & 42FT W/O C/L INT OAK AVE | CG 3590 |
| ARCADIA (1975) | 505.492 | RDBM TAG 1FT W BCR 32FT S & 69FT W C/L INT DUARTE RD & TEMPLE CITY BLVD | CG 3591 |
| BASELINE (1975) | 654.356 | RDBM TAG 1FT E/O BCR @ NE COR SERV RD ENT & FOOTHILL BLVD 26FT E & 27FT N C/L INT 246FT W INT DON ALVARADO DR | CG 3594 |
| BASELINE (1975) | 315.725 | RDBM TAG 2FT N BCR 74FT N & 40FT E C/L INT LOWER AZUSA RD & BALDWIN AVE PROD TO N | CG 3601 |
| BASELINE (1975) | 719.875 | L&BN 2FT S/O BCR 49FT S & 32FT W C/L INT COLORADO BLVD & SAN GABRIEL BLVD | CG 3603 |
| BASELINE (1975) | 694.722 | L&BN 4FT N/O BCR @ S END C B 60FT N & 30FT W C/L INT DEL MAR BLVD & SAN GABRIEL BLVD | CG 3604 |
| BASELINE (1975) | 693.950 | L&BN W CB 1FT N/O BCR 55FT S & 30FT W C/L INT DEL MAR BLVD & SAN GABRIEL BLVD | CG 3605 |

| QUAD-YEAR | ELEV | DESCRIPTION (INCLUDE QUAD AND YEAR IN DESCRIPTION) | BM NUMBER |
|--------------------|---------|---|-----------|
| ARCADIA (1975) | 527.370 | L&T W CB 1FT S/O BCR 63FT S & 36FT W C/L INT DUARTE RD & SAN GABRIEL BLVD | CG 3607 |
| ARCADIA (1975) | 432.000 | L&SPK 6FT E/O BCR 52FT N & 60FT E/O C/L INT SAN GABRIEL BLVD & LAS TUNAS DR | CG 3608 |
| ARCADIA (1975) | 412.200 | LAFC BR DISC SW COR OF BRIDGE OVER RUBIO WASH 50FT W & 100FT S/O C/L INT SAN GABRIEL BLVD & WEDGEWOOD PL MKD (RW 58-201 1940) | CG 3609 |
| ARCADIA (1975) | 384.661 | CITY OF SAN GABRIEL 1 1/2IN BR DISC MON IN WELL INT SAN GABRIEL BLVD & EL MONTE ST TO THE W | CG 3610 |
| BASELINE (1975) | 307.482 | L & BN 1FT S BCR 105FT S & 20FT W C/L LOWER AZUSA RD & SHIRLEY AVE | CG 3611 |
| BASELINE (1975) | 304.562 | L & T 15FT N BCR 68FT N & 27 FT W C/L INT LOWER AZUSA RD & EL MONTE AVE | CG 3614 |
| BASELINE (1975) | 330.489 | LACS MON FL @ SW COR FIRE STATION NO 57 43FT N & 50FT E C/L INT PECK RD & CHERRYLEE DR TO W (MKD SW COR LOT 5) | CG 3615 |
| BASELINE (1975) | 331.160 | LACS MON 0.4FT UP @ NW COR FIRE STATION NO 57 128FT N & 50FT E C/L INT PECK RD & CHERRYLEE DR TO W (MKD NW COR LOT 5) | CG 3616 |
| BASELINE (1975) | 332.181 | RDBM MON IN WELL 8IN DN @ C/L INT PECK RD & RIO HONDO PKWY | CG 3617 |
| BASELINE (1975) | 358.247 | LAFC MON FL @ SW COR BRIDGE NO 8930 33FT S & 63FT E C/L INT MYRTLE AVE & LONGDEN AVE (MKD BM 067-00565 1965) | CG 3619 |
| BASELINE (1975) | 499.947 | RDBM TAG 3FT E BCR 36FT N & 60FT E C/L INT HUNTINGTON DR & MYRTLE AVE | CG 3620 |
| BASELINE (1975) | 635.501 | L & BN IN N CB OF SERVICE RD 68FT N & 105FT E C/L INT FOOTHILL BLVD & BALDWIN AVE | CG 4015 |
| BASELINE (1975) | 652.354 | LACS MON IN WELL 10IN DN @ APPROX C/L INT SANTA ANITA AVE (E BARREL) & SIERRA MADRE BLVD MKD I-5 | CG 4031 |
| BASELINE (1975) | 587.370 | LACS MON IN WELL 11IN DN 10FT E & 3FT S C/L INT SANTA ANITA AVE (E BARREL) & ORANGE GROVE AVE MKD (I-6A) | CG 4032 |
| ARCADIA (1975) | 397.515 | CSBM DISC 1FT BACK OF W CB & 19FT N/O BCR @ N END C B @ NW COR SAN GABRIEL BLVD & ANGELINA AVE 36FT W & 59FT N/O C/L INT MKD (BM 1-28A 1971 | CG 4115 |

| QUAD-YEAR | ELEV | DESCRIPTION (INCLUDE QUAD AND YEAR IN DESCRIPTION) | BM NUMBER |
|--------------------|---------|--|-----------|
| ARCADIA (1975) | 430.747 | LACS BM DISC 1FT BK OF W CB 42FT S/O BCR N END OF C B @ SW COR SAN GABRIEL BLVD & LAS TUNAS DR 36FT W & 98FT S/O C/L INT MKD (BM 10-1B 1971) | CG 4116 |
| ARCADIA (1975) | 445.960 | LACS BM DISC 1FT BK OF W CB @ SW COR SAN GABRIEL BLVD & HERMOSA DR 36FT W & 109FT S/O C/L INT MKD (BM 10-1C 1971 RE 5869) | CG 4117 |
| ARCADIA (1975) | 483.252 | LACS BM DISC FL IN CONC 1FT BK OF W CB 5FT S/O BCR @ SW COR LONGDEN AVE & SAN GABRIEL BLVD 39FT S & 40FT W C/L INT MKD (BM 10-2A 1971 RE 5869) | CG 4118 |
| ARCADIA (1975) | 530.783 | LACS BM DISC 0.7FT BK OF CB N WALL OF C B @ NW COR DUARTE RD & SAN GABRIEL BLVD 36FT W & 59FT N/O C/L INT MKD (BM 10-4A 1975 RE 7078) | CG 4119 |
| ARCADIA (1975) | 599.491 | LACS BR CAP 1FT BK OF E CB 5FT N/O BCR S END C B @ NE COR HUNTINGTON DR & SAN GABRIEL BLVD 107FT N & 41FT E C/L INT MKD (BM 10-5A 1966) | CG 4120 |
| ARCADIA (1975) | 651.483 | LACS BM MON IN WELL 2FT BK OF E CB 4FT N/O BCR @ SE COR LOMBARDY RD & SAN GABRIEL BLVD 59FT S & 32FT E/O C/L INT MKD (BM 10-6A 1971 RE 5869) | CG 4121 |
| BASELINE (1975) | 661.669 | RDBM TAG IN E CB 6FT N/O BCR S END OF C B @ NE COR CALIFORNIA BLVD & SAN GABRIEL BLVD 52FT N & 27FT E C/L INT | CG 4122 |
| BASELINE (1975) | 694.299 | LACS BM DISC E CB 19FT N/O BCR N END C B @ NE COR DEL MAR BLVD & SAN GABRIEL BLVD 75FT N & 30FT E C/L INT MKD (BM 10-7A 1971 RE5869) | CG 4123 |
| BASELINE (1975) | 718.344 | LACS BM DISC 1FT W/O W CB @ SW COR COLORADO BLVD & SAN GABRIEL BLVD 107FT S & 32FT W C/L INT MKD (BM 10-7B 1971 RE5869) | CG 4124 |
| BASELINE (1975) | 741.908 | LACS BM DISC 1FT W/O W CB N WALL C B 14FT N/O BCR @ NW COR FOOTHILL BLVD & DAISY AVE 65FT N & 19FT W C/L INT MKD (BM10-8B 1971 RE 5869) | CG 4125 |
| BASELINE (1975) | 702.898 | RAMSET N CB 1FT W/O BCR @ NW COR HALSTEAD ST & FOOTHILL BLVD 62FT W & 33FT N C/L INT | CG 4126 |
| BASELINE (1975) | 701.592 | RDBM TAG N CB 1FT E/O BCR @ NE COR HALSTEAD ST & FOOTHILL BLVD 63FT E & 33FT N C/L INT | CG 4127 |
| BASELINE (1975) | 691.782 | RDBM TAG S CB 7FT E/O BCR @ SW COR ROSEMEAD BLVD & FOOTHILL BLVD 71FT W & 40FT S C/L INT | CG 4128 |
| BASELINE (1975) | 693.362 | LACS BM DISC 1FT N/O N CB 4FT E/O BCR @ NE COR ROSEMEAD BLVD & FOOTHILL BLVD 68FT E & 49FT N C/L INT MKD (BM 10-9C 1971 RE5869) | CG 4129 |

| QUAD-YEAR | ELEV | DESCRIPTION (INCLUDE QUAD AND YEAR IN DESCRIPTION) | BM NUMBER |
|--------------------|---------|--|-----------|
| BASELINE (1975) | 678.983 | LACS BM DISC 1FT W/O W CB N WALL C B @ NW COR FOOTHILL BLVD & MICHILLINDA AVE 82FT N & 41FT W C/L INT MKD (BM 10-10A 1971 RE5869) | CG 4130 |
| BASELINE (1975) | 675.379 | RDBM TAG S CB 1FT E/O BCR @ SE COR FOOTHILL BLVD & MICHILLINDA AVE 83FT E & 39FT S C/L INT | CG 4131 |
| BASELINE (1975) | 654.417 | LACS BM DISC 4FT BK WK N CB W WALL C B 6FT E/O BCR @ NE COR SERV RD ENT & FOOTHILL BLVD 32FT E & 31FT N C/L INT 241FT W INT DON ALVARADO DR MKD (BM 10-11A 1971 RE5869) | CG 4132 |
| BASELINE (1975) | 550.039 | LAFC BR DISC W WINGWALL STORM DRAIN CHANNEL 37FT N C/L FOOTHILL BLVD & 381FT E INT RANCHO RD MKD (BM 062 31125 1967) | CG 4133 |
| BASELINE (1975) | 543.866 | L&SPK CTR CB RET @ SW COR FOOTHILL BLVD & SANTA ANITA AVE 51FT S & 50FT W C/L INT | CG 4134 |
| BASELINE (1975) | 577.828 | LACS BM DISC 1FT N/O N CB W END C B 4FT E/O BCR @ NE COR FOOTHILL BLVD & MYRTLE AVE 43FT E & 32FT N C/L INT MKD (BM 11-7B 1974 RE7078) | CG 4135 |
| BASELINE (1975) | 354.453 | LACS BM MON IN WELL 1FT N/O N CB 21FT W/O BCR @ NW COR MISSION DR & BARTLETT AVE TO N 73FT W & 33FT N C/L INT MKD (BM 19-2A 1971 RE7078) | CG 4146 |
| BASELINE (1975) | 346.169 | RDBM TAG S CB 1FT W/O BCR @ SW COR MISSION DR & MUSCATEL AVE 25FT W & 32FT S C/L INT | CG 4147 |
| BASELINE (1975) | 344.959 | RDBM TAG S CB 1FT E/O BCR @ SE COR MISSION DR & MUSCATEL AVE 80FT E & 32FT S C/L INT | CG 4148 |
| BASELINE (1975) | 333.381 | LACS BR CAP MON 1FT W/O W CB 48FT N/O BCR @ NW COR MISSION DR & ROSEMEAD BLVD 152FT N & 43FT W C/L INT MKD (BM 19-3A 1971 RE7078) | CG 4149 |
| BASELINE (1975) | 314.649 | LACS BM DISC 1FT S/O S CB W END C B 32FT W/O BCR @ SW COR LOWER AZUSA RD & TEMPLE CITY BLVD 99FT W & 32FT S C/L INT MKD (BM 19-5B 1975 RE7078) | CG 4150 |
| BASELINE (1975) | 312.638 | RDBM TAG N CB W END C B 32FT N C/L LOWER AZUSA RD & 99FT E INT ELLIS LN | CG 4152 |
| BASELINE (1975) | 307.369 | LACS BR CAP MON IN WELL C/L ARDEN DR & 100FT N INT LOWER AZUSA RD MKD (RE 5869) | CG 4155 |
| BASELINE (1975) | 315.698 | RDBM TAG S CB 1FT E/O BCR @ SW COR LOWER AZUSA RD & SANTA ANITA AVE 84FT W & 32FT S C/L INT | CG 4156 |

| QUAD-YEAR | ELEV | DESCRIPTION (INCLUDE QUAD AND YEAR IN DESCRIPTION) | BM NUMBER |
|--------------------|---------|--|-----------|
| BASELINE (1975) | 316.630 | LACS BR DISC 1FT N/O N CB W END C B 45FT E/O BCR @ NE COR LOWER AZUSA RD & SANTA ANITA AVE 107FT E & 33FT N C/L INT MKD (BM 19-8A 1971 RE7078) | CG 4157 |
| BASELINE (1975) | 322.622 | RDBM TAG 1FT W/O BCR @ SW COR LOWER AZUSA RD & PECK RD 32FT S & 96FT W/O C/L INT | CG 4161 |
| BASELINE (1975) | 323.484 | CS BM MON FL IN S WALL C B 42FT N/O BCR @ NE COR PECK RD & LOWER AZUSA RD 39FT E & 107FT N/O C/L INT MKD (BM 15-4D 1971) | CG 4162 |
| BASELINE (1975) | 432.151 | L&T 16FT N/O BCR @ SW COR MYRTLE AVE & DUARTE RD 43FT W & 60FT S/O C/L INT | CG 4163 |
| BASELINE (1975) | 590.281 | L&BR CTR CB RET @ SW COR SANTA ANITA AVE & ORANGE GROVE AVE 52FT W & 25FT S C/L INT | CG 4187 |
| BASELINE (1975) | 656.398 | FC L&TAG CTR CB RET @ NE COR SANTA ANITA AVE & SIERRA MADRE BLVD 44FT E & 33FT N C/L INT | CG 4188 |
| ARCADIA (1975) | 537.420 | RDBM TAG E CB BALDWIN AVE 1FT N/O @ NW COR STANFORD DR 67FT N/O C/L & 40FT E/O C/L INT | CG 4333 |
| ARCADIA (1975) | 494.463 | RDBM TAG IN W CB BALDWIN AVE 1FT S/O BCR 44FT W & 60FT N/O INT N BARREL HUNTINGTON DR | CG 4334 |
| ARCADIA (1975) | 479.128 | CO ENG BR CAP MON 4FT E/O E CB BALDWIN AVE 35FT E & 117FT N/O C/L INT DUARTE RD MKD (BM 20-5A 1966 RE 5869) | CG 4335 |
| ARCADIA (1975) | 372.443 | RDBM TAG N CB 1FT W/O BCR 46FT W & 18FT N/O C/L INT BROADWAY & N ENCINITA AVE | CG 4336 |
| ARCADIA (1975) | 343.785 | PK IN MC ISLAND CB 4FT S & 42FT E/O C/L TYLER AVE & LIVE OAK AVE | CG 4337 |
| ARCADIA (1975) | 643.193 | RDBM TAG IN N CB 1FT W/O BCR @ NW COR MICHILLINDA AVE & COLORADO BLVD 42FT N & 31FT W/O C/L INT | CG 4338 |
| ARCADIA (1975) | 640.682 | RDBM TAG IN E CB 1FT S/O BCR @ SE COR MICHILLINDA AVE & COLORADO BLVD 46FT S & 42FT E/O C/L INT | CG 4339 |
| ARCADIA (1975) | 542.284 | L&T N CB HUNTINGTON DR S BARREL 17FT W/O ISLAND BCR 55FT W/O C/L SUNSET BLVD | CG 4340 |
| ARCADIA (1975) | 542.326 | L&T N CB HUNTINGTON DR N BARREL 4FT W/O BCR @ NW COR SUNSET BLVD E END C B | CG 4341 |
| ARCADIA (1975) | 506.266 | L&T W CB 3FT N/O BCR @ NW COR SUNSET BLVD & DUARTE RD 68FT N & 30FT W/O C/L INT | CG 4342 |

| QUAD-YEAR | ELEV | DESCRIPTION (INCLUDE QUAD AND YEAR IN DESCRIPTION) | BM NUMBER |
|--------------------|---------|---|-----------|
| ARCADIA (1975) | 438.109 | L&T 7FT N/O BCR INTO RET @ SW COR TEMPLE CITY BLVD & LONGDEN AVE 38FT S & 34FT W/O C/L INT | CG 4343 |
| ARCADIA (1975) | 448.231 | RAMSET & WASHER IN N CB NR BCR @ NW COR LONGDEN AVE & OAK AVE 20FT N & 45FT E/O C/L INT | CG 4344 |
| ARCADIA (1975) | 468.154 | FC TAG 2FT BACK OF CF IN C B 37FT N & 22FT E/O C/L INT LONGDEN AVE & MUSCATEL AVE | CG 4345 |
| ARCADIA (1975) | 467.861 | L&T MCR @ NW COR LONGDEN AVE & MUSCATEL AVE 25FT N & 33FT W/O C/L INT | CG 4346 |
| ARCADIA (1975) | 527.088 | L&T CTR CB RET SW COR SUNSET BLVD & FAIRVIEW AVE 30FT S & 36FT W/O C/L INT | CG 4347 |
| ARCADIA (1975) | 527.401 | L&T CTR CB RET NE COR SUNSET BLVD & FAIRVIEW AVE 30FT N & 36FT E/O C/L INT | CG 4348 |
| ARCADIA (1975) | 402.271 | L&T 1FT N/O BCR @ SW COR CHULA ST & PECK RD 20FT W & 41FT S/O C/L INT | CG 4349 |
| BASELINE (1975) | 356.751 | L&T 17FT N/O BCR @ NE CORNER WALNUT GROVE AVE & MISSION DR 66FT N & 30FT E/O C/L INT | CG 4350 |
| ARCADIA (1975) | 422.407 | SPK 5FT W/O BCR @ NW COR LAS TUNAS DR & BURTON AVE 55FT N & 41FT W/O C/L INT | CG 4351 |
| ARCADIA (1975) | 327.659 | LACO FC TAG 4FT N/O BCR @ NW COR FREER ST & EL MONTE AVE 47FT N & 28FT W/O C/L INT | CG 4352 |